

MAPS

MAPS, U.S.

1914 Atlas of the European Conflict
1941 Guide to the Great Smoky Mountains National Park
1947 AAA Road Map of the Northeastern States
1947 AAA Road Map of the North Central States
1948 AAA Road Map of the South Central States
1948 Map of Cape Cod
1949 Esso Road Map of the Northeast United States
1951 Hurricane Plotting Guide
1958 Universal Map of the World
1962 Road Atlas of the United States, Canada, and Mexico
1970 Travel Atlas
1991 Rand McNally Road Atlas of the United States, Canada, and Mexico
2000 Florida Relocation Guide, Pasco and Pinellas Counties
Shell Map of Alabama, undated
Shell Map of Louisiana, undated
Shell Map of San Francisco, Oakland, undated
Travel California and Nevada with Conoco
Travel Colorado with Conoco, undated
Travel South Dakota with Conoco
Travel Texas with Conoco, undated
Travel Utah with Conoco, undated
Travel Washington with Conoco, undated
Travel Wyoming with Conoco, undated

ORIGINAL MAPS

1879 Tampa Bay coastal chart, 26 x 42”

1882 Map of Hillsborough County and original Disston Purchase, showing Bonafacio



1886 Florida Railroad and Township Map (showing Disston City), 18x 23"
Copies 36 x 50" and 18 x 23"

1905 Terminus of St. Petersburg and Gulf RR., 14 x 20, color. Copies



1925 Pasadena on the Gulf Map, color, 48 x 25" fragment



1938 Gulfport promotional map, Map of Gulfport, Florida, 9 x 12" Signed and dated, Frank Mills,



1943 Tampa Bay and St. Joseph's Sound, U.S.C.G., color, 34 x 40"

1945 St. Petersburg Municipal Transit System Map, 16 x 16"



1985 (1927) Gulfport: Pasadena Estates Area and Southern Portion of City, drawn by W.B. Simonds, 6/1985, 8-1/2 x 11”

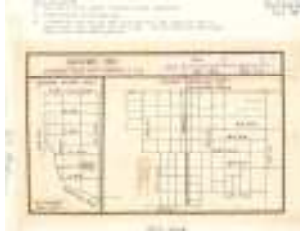

1985 Barnett, Torres, and Miranda Homesteads, drawn by W.B. Simonds, 4 ½ x 8 ½” from original sketch by Florence Slaughter Jerrett, c. 1963. 4 copies



Four hand drawn maps (LB) of locations of early platting and some homesteads, 14 x 17”

Gulfport Street Maps

1979 Disston City locations, W.B. Simonds 7/18/83. Historical notes by Bernice R. Perry. 2 copies, unmarked. 1 copy, slightly different edition, with Florida Road map marked by Ellis Shapiro 11/20/84 for annexation of PYCC area.

c. 1983 Gulfport street map, The New Gulfport Street Map, 23 x 29”. Tampa Bay Area Map on reverse. Typed note: “received from Cecil Slauter 7/6/83, marked up by Irving Slaughter

Undated 18 x 21” Gulfport Illustrated Pocket Map, GCofC

Undated 11 x 18” Gulfport Pocket Map, GCofC

Undated 8 ½ x 11” Gulfport: The Secret is Out, GMA

c. 2007 11 x 17” Gulfport Redevelopment Districts realtor “FAM” Tour,

Gulfport Zoning/Plat Maps

1908 West Oakland plat map, blueprint, 18 x 24”

1913 Plat of Boca Ceiga Park, 8 ½ x 11”

1925 Roebuck’s Replat, photocopy, 14 x 19 ½”

1928 Pasadena estates, Section F, 18 x 22” 3 copies

1940 Plat map showing Al Capone property and north end of Clam Bayou, 7 x 12"



1960 City of Gulfport zoning map, blueprint, 26 x 30"

1961 Boundaries of Gulfport, St. Petersburg, South Pasadena, St. Pete Beach, 20 x 32"

1984 Property Appraiser's book of plats, blueprints

1985 Real Estate Atlas of Pinellas County, South. Approximately 500 pages.

5/1985 City of Gulfport zoning map, blueprint, 30 x 36"

Undated Northwest Gulfport zoning maps (2), 20 x 30"

Undated book of all plats, 40 sheets, 30 x 35"

Undated book of all plats

Undated book of all plats WORKING COPY

Gulfport, Assorted Maps

1963 Proposed Municipal Beach Improvements

1/17/1975 Sanitary Sewer System map, blueprint, 22 x 36"

1979 SFWMD map, Northeast Gulfport (north of 22nd Avenue, east of 58th Street). Blueprint, 27 x 30"

1991 Conceptual Future Land Use map, Gulfport Planning Department, blueprint, 30 x 42"

1992 Proposed Historic District, 24 x 24" 4 copies

1996 Brick Streets, blueprint, 30 x 41"

1996 Municipal Comprehensive Plan, Gulfport Public Services Department, blueprint, 32 x 42"

1999 Gulfport Evacuation Zones, 11 x 17"

Undated street map with "old houses" indicated, unattributed

Undated FEMA Impact Zones, 8 ½ x 11"

Undated Gulfport Building Heights, 11 x 17"

Gulfport Promotional Maps and Brochures

Undated 10 x 14" Gulfport promotional map, 1/s, 2 copies

Undated 10 x 14" Gulfport promotional map: City of Gulfport, the Friendly City Ideal for Outdoor Living Winter and Summer, GCofC, 1/s 10 x 14" Gulfport promotional map, 2/s, GCofC, same but no PYCC drawn on, 3 copies (one marked with Golf Course information)

Undated 22 x 29" Gulfport promotional map, Gateway to the Gulf

c. 2006 8 ½ x 11" City of Gulfport City-Wide Yard Sale Brochure, November 10th

Undated and unattributed 8 ½ x 11" (2) and 11 x 17" (1) handwritten notes for Trolley Tour, 2 pages

PHOTOCOPIES OF MAPS, ORIGINALS UNAVAILABLE

Pre-Settlement

- Pinellas and Tampa Bay, from large wall map
- La Floride and Golfe de Mexique (2)
- United States and Texas
- Entrances to Tampa Bay (3)

Early Settlement

- Hand drawn map of early homesteads (4)
- Route of railroads into Tampa and Pinellas (3)
- West Oakland, as platted in 1905 (2)

Undated Color Map of Tampa Bay area showing Bonifacio, 8 ½ x 11”



Settlement Map of Lower Pinellas, showing location of Glen Oaks Cemetery, 8 ½ x 11”



1848 Survey, Sections 5 – 36, with homesteads to 1879, 8 ½ x 11” (5 copies)



1881 Subdivision of Lots, Torres Lot, and Miranda Wharf, 8 ½ x 11”

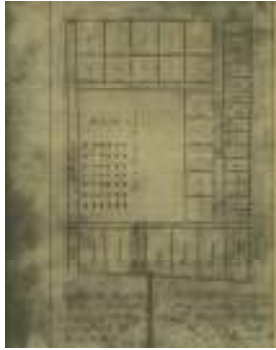

1925 St. Petersburg Chamber of Commerce Street Map, one copy 24 x 36”, one copy hanging, one copy on card stock, two pieces 18 x 24”

Pasadena Golf Course, 8 ½ x 11” from large map



Undated photocopy of map of area west of 58th Street, drawn by Norma Huckins, 8 ½ x 11”

Undated 8 ½ x 11” Water Lots 3-7

1962 Copy 11 x 17” Blueprint of some of Disston City Land Purchases, including Section 33

Undated 8 ½ x 11”, Similar to above, showing hotel in different position (3 copies)

PLANS

1926 Proposed town hall plans

1928-1932 Burials at Glen Oak Cemetery plan

1953 City Hall Specifications

1955 West half of Chase Park, for proposed Shuffleboard Court addition

1999 Hickman Theater plans

2000 Proposed Casino restoration plans

2001 Final Site Plans Tomlinson Park Expansion, plus photo maps

See also individual files, such as Pier and Casino

